

## pressure transmitter with local readout, for homogenizer DS 4" (100mm)



EMC 2014/30/EU  
PED 2014/68/EU



74-06

Authorization NO. 1599

**Ranges:** from 0...1500 to 0...20000 psi, relative  
(from 0...100 to 0...1600 bar or equivalent units).  
**Accuracy (% VFS):** local readout,  $\leq 1.0$  ( $\leq 1.6$  for pressure ranges  $> 8700$  psi - 600 bar); transmitter,  $\leq 0.5$ .  
**Working pressure:** 75% max of FSV.  
**Over pressure:** not suitable.  
**Ambient temperature:** 14...+149 °F (-10...+65 °C).  
**Process temperature:** 14...+248 °F (-10...+120 °C).  
Max 302°F (150 °C) for 1 hour during sterilization (S.I.P)<sup>1</sup>.  
**Output signals:** for pressure ranges  $\leq 8700$  psi (600 bar) :  
4...20 mA, 0...5 Vdc, 0...10 Vdc;  
for pressure ranges  $> 8700$  psi (600 bar) : 4...20 mA.  
**Sensor calibration :** limit-point as per DIN 16086.  
**Zero calibration:**  $\pm 10$  % span typical.  
**Span calibration:**  $\pm 10$  % span typical.  
**Compensated temperature range:** 14...+176 °F; (-10...+80 °C).  
**Thermal drift:**  $\leq 0.011$  % span / °F ( $\leq 0,02$  % span/ °C).  
**Annual drift:**  $\leq 0,2$  % of span.  
**Supply and max load:** see on page 2.  
These types of sensors are intended for Manual (COP) Cleaning.

1) S.I.P. = Steamed In Place

### 8.MOM.1 - Standard Model

**Designation code:** S1 as per EN 837-2.  
**Electric connection:** junction box as per VDE with exit for cables  $\varnothing 0.27...0.51$ " (7...13mm).  
**Sensor:** ceramic thick film or stainless steel thin film.  
**Protection degree:** IP 55 as per EN 60529/IEC 529.  
**Diaphragm:** AISI 316L st.st.  
**Diaphragm seal:** AISI 316L st.st. with finishing  $Ra \leq 0,8 \mu m$  (welded parts included).  
**Bourdon tube:** AISI 316L st.st. seamless tube.  
**Ring:** stainless steel, bayonet lock.  
**Window:** tempered glass.  
**Movement:** stainless steel.  
**Dial:** aluminium, white with black markings.  
**Pointer:** adjustable, aluminium, black.

### 8.MOM.3 - Filled Model

**Filling liquid:** dielectric oil.  
**Protection degree:** IP 67 as per EN 60529/IEC 529.  
**Other features:** as standard model.

**pressure transmitter with local readout,  
for homogenizer, DS 4" (100mm)**

**MT OM**

RC6 - 02/16

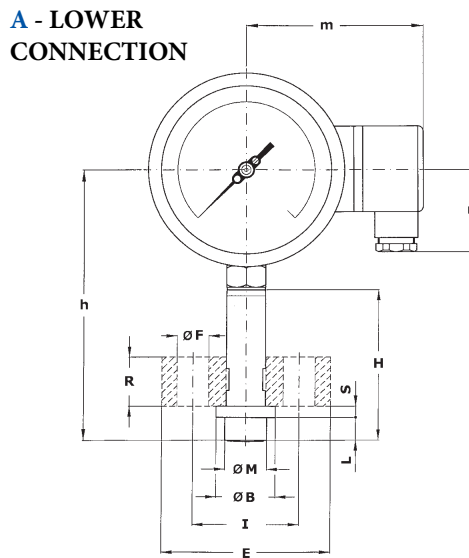
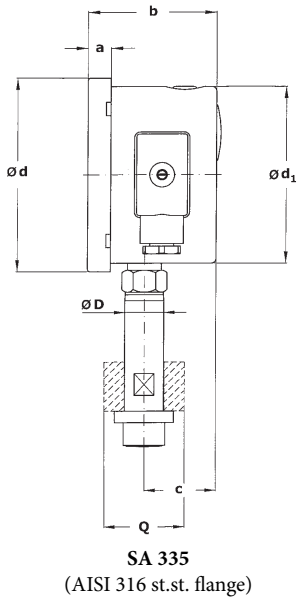

a	b	c	d	d <sub>1</sub>	h	m	n
0.51"	2.84"	1.59"	4.35"	3.97"	6.08"	3.66"	1.85"
(13)	(72,3)	(40,6)	(110,6)	(101)	(154,5)	(93,1)	(47)

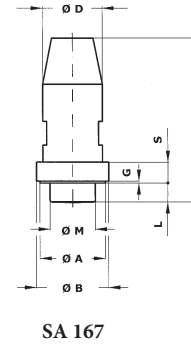

Drawing	Ø D	Ø M	Ø A	Ø B	H	S	G	L	Es	E	Ø F	I	R	Q	T	Weight
<b>335</b> SA 335	0.86"	0.95"		1.30"	3.38"	0.33"		0.51"		3.74"	0.70"	2.36"	1.10"	1.77"		4.01 lbs (1,82 kg)
<b>167</b> SA 167	1.22"	0.95"	1.33"	1.47"	3.38"	0.43"	0.04"	0.39"								2.84 lbs (1,29 kg)

dimensions : inches (mm)

Output signals	4...20 mA	0...5 Vdc	0...10 Vdc
	<b>1</b>	<b>4</b>	<b>5</b>
Nr. of wires	2	3	3
Load (Ohm)	$R_L \leq (V_{in}-10)/0,02$	$R_L \geq 5 \text{ K}\Omega$	$R_L \geq 10 \text{ K}\Omega$
Supply: +Vin	10...30	8...30	14...30
Ground	(pls. refer to Installation Manual)		

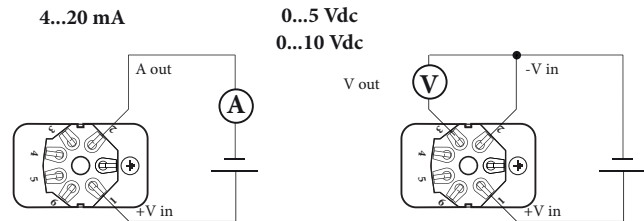

**OPTIONS**

<b>C01</b> - Calibration report
<b>S35</b> - Process connection dwg. SA 335, without flange
<b>T31</b> - Plexiglas window

**“HOW TO ORDER” SEQUENCE**

Section / Model / Case / Mounting / Diameter / Range / Process connection / Output signal / Options  
**8 MOM 1 A E 335 1 C01**  
**167 3 4 S35**  
**5 T31**

